

# Red Class B Engineer - Perforated

## Product Technical Information Sheet

Wienerberger Code	24190000
Production Plant	Sandown
Manufacture	Extruded/Wirecut
Configuration	Perforated
Colour	Red
Appearance	Smooth
Work Size (mm)	215 x 102.5 x 65
Pack Quantity	504 No.
Individual Dry Brick Weight (kg)	1.950

## Technical Properties to BS EN 771-1

Size Tolerance (Mean/Range)	T2/R1
Gross Dry Density (kg/m <sup>3</sup> /Tolerance)	1360 (D1)
Compressive Strength (N/mm <sup>2</sup> )	≥75
Thermal Conductivity (W/(m·K)) λ <sub>10,dry,unit</sub> value (EN 1745 tabulated: S1)	P=90% 0.79
Durability Designation	F2
Water Absorption (%)	≤7 (EN 772-7)
Initial Rate of Water Absorption (kg/(m <sup>2</sup> ·min))	Min. 0.0 Max. 0.4
Active Soluble Salts	S2
Reaction to Fire	Class A1

**Issue Date: 19/08/2020**

Engineering bricks are specified for their physical characteristics and not their appearance. They have high compressive strength and low water absorption and are classified only by these properties. Their use for facing work should be avoided, as they are not subject to the same level of inspection for surface irregularities or colour variation as a facing brick. Where aesthetic performance is a major consideration, facing bricks must be used.

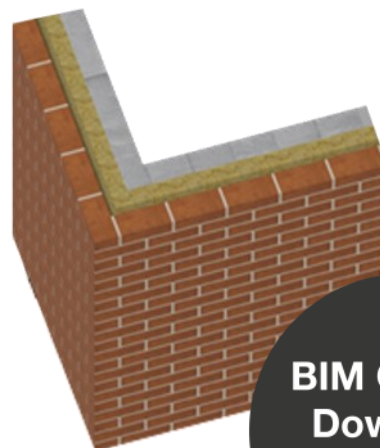

**BIM Objects  
Download**

