

# Corn Yellow

## Product Technical Information Sheet

Wienerberger Code	12708510
Production Plant	Peruwelz (Belgium)
Manufacture	Soft Mud Moulded Stock
Configuration	Frogged
Colour	Yellow Multi
Appearance	Creased/Textured
Work Size (mm)	215 x 102.5 x 65



## Technical Properties to BS EN 771-1

Size Tolerance (Mean/Range)	T1/R1
Gross Dry Density (kg/m <sup>3</sup> /Tolerance)	1450 (D1)
Compressive Strength (N/mm <sup>2</sup> )	≥12
Thermal Conductivity (W/(m·K)) λ <sub>10,dry,unit</sub> value (EN 1745 tabulated: S1)	P=90% 0.69
Durability Designation	F2
Water Absorption (%)	≤19
Initial Rate of Water Absorption (kg/(m <sup>2</sup> ·min))	Min.1.0 Max. 5.0
Active Soluble Salts	S2
Reaction to Fire	Class A1

**Issue Date: 09/07/2020**

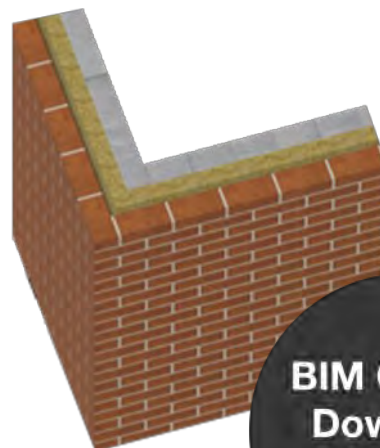

**BIM Objects  
Download**

